

# ENCLOSURE D

Rosa  
Architectural  
Group  
Inc.

1084 Sterling Street  
St. Paul, Minnesota 55119  
tel: 651-739-7988  
fax: 651-739-3165

PROPOSED  
BUILDING FOR  
BLAINE  
BROTHERS  
TRUCKALINE

COLUMBUS, MN

CLASSIC  
CONSTRUCTION

PH: 763-434-8870  
18542 ULYSSES ST. NE  
EAST BETHEL, MN

I HEREBY CERTIFY THAT THIS PLAN, SPECIFICATION, OR REPORT WAS PREPARED BY ME OR UNDER MY DIRECT SUPERVISION AND THAT I AM A DULY LICENSED PROFESSIONAL UNDER THE LAWS OF THE STATE OF MINNESOTA.

PRINT NAME: \_\_\_\_\_

SIGNED: \_\_\_\_\_

DATE: \_\_\_\_\_ REG. NO. \_\_\_\_\_

I HEREBY CERTIFY THAT THIS PLAN, SPECIFICATION, OR REPORT WAS PREPARED BY ME OR UNDER MY DIRECT SUPERVISION AND THAT I AM A DULY LICENSED ARCHITECT UNDER THE LAWS OF THE STATE OF MINNESOTA.

PRINT NAME: \_\_\_\_\_

SIGNED: \_\_\_\_\_

DATE: \_\_\_\_\_ REG. NO. \_\_\_\_\_

PROJECT NUMBER: 22230

DATE: DECEMBER 20, 2022

DRAWN BY: JL

CHECKED BY: RR

REVISIONS: \_\_\_\_\_

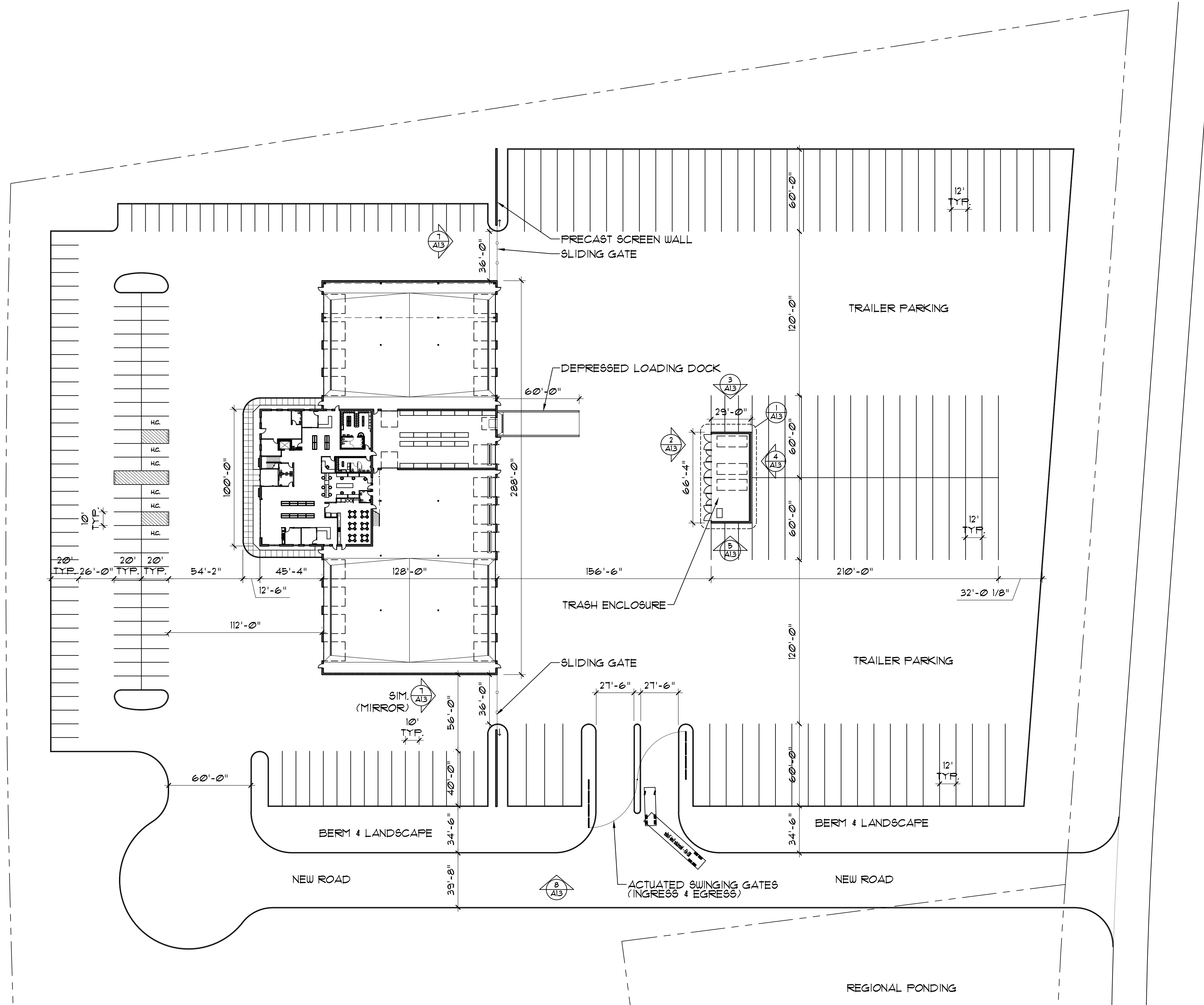

1  
A12 ENLARGED SITE PLAN  
1" = 40'-0" (ON 24x36 SHEET)



PARKING STALLS INDICATED:  
119 TOTAL STALLS SHOWN  
6 H.C. STALLS SHOWN  
16 TRUCK STALLS SHOWN  
141 STALLS TOTAL  
88 TRAILER STALLS SHOWN

ENLARGED SITE PLAN

# A1.2